



AFINION™

CRP

QUICK REFERENCE GUIDE



Preparing for analysis

AFINION™ CRP Test Cartridge

- Store the test kit refrigerated (2-8°C) until the expiry date or at room temperature (15-25°C) for maximum 4 weeks.
- The test cartridge must reach a temperature of 15-30°C before use; leave the unopened foil pouch on the bench for at least 15 minutes.
- Use the test cartridge within 10 minutes after opening the foil pouch.
- Hold the test cartridge by the handle.

Patient Sample

- Use capillary blood directly from finger, venous whole blood (with EDTA or heparin), serum or plasma.
- Venous whole blood should be analysed within 3 days. Serum or plasma can be stored refrigerated (2-8°C) for 10 days. Capillary samples cannot be stored.
- Mix the sample by inverting the tube 8-10 times before use.

AFINION™ CRP Control

- Store the controls refrigerated (2-8°C). Opened controls are stable for 4 weeks.
- The control can be used directly from the refrigerator.
- Mix the control by inverting the vial 8-10 times before use.
- The measured value should be within the acceptable range stated in the Afinion™ CRP Control Package Insert.

AFINION™ 2 Analyzer

- Switch on the analyzer and optionally enter the operator ID.
- Analyse patient samples and controls following the test procedure on the reverse side.
- An information code might be displayed during analysis. The possible causes and actions to take are listed in the **AFINION™ 2 Analyzer User Manual**.



Information codes specific for the AFINION™ CRP assay:

Code	Cause
101	Hematocrit below 20%
102	Hematocrit above 60%



Consult the AFINION™ User Instructions for complete information:

- Afinion CRP Package Insert.
- Afinion CRP Control Package Insert.
- **AFINION 2 Analyzer User Manual**.

Testing Procedure

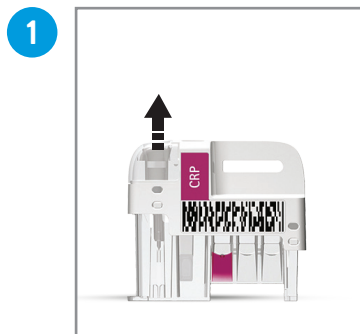

Pull the sampling device straight up from the test cartridge.

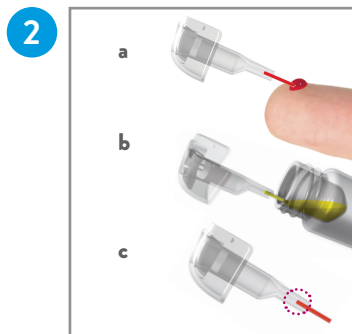

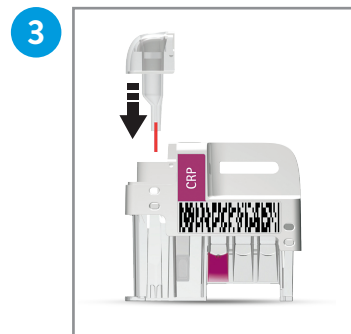

Fill the capillary completely (c) with patient sample (a) or control (b). Do not wipe off the capillary.



Replace the sampling device immediately. Analysis of the test cartridge must start within 1 minute.



Touch  for patient samples, or touch  for controls. The lid opens automatically.





Insert the test cartridge with the barcode facing left.



Close the lid manually to start analysing.



Touch  and enter patient ID, or touch  and enter control ID. Touch  to confirm.



Record the result when it appears on the screen. Touch  to accept. The lid opens automatically.



Remove and immediately discard the used test cartridge. Close the lid manually when the analyzer is not in use.